



2001 Cessna Citation Bravo

550B-0969 N119LC



This aircraft is being brokered by East Coast Jet Center, Inc. Prospective purchasers are encouraged to conduct their own independent pre-purchase inspection as East Coast Jet Center, Inc. makes no representations as to the airworthiness of the aircraft or the accuracy of the above information. Specifications subject to verification upon inspection. Aircraft subject to prior sale.

GLOBAL HEADQUARTERS
5525 N.W. 15th Avenue, Suite 301B · Fort Lauderdale, Florida 33309
+1 (954) 703-1600 · www.eastcoastjetcenter.com

FORT LAUDERDALE * MONTERREY * SAO PAULO * MOSCOW

2001 Cessna Citation Bravo

550B-0969 N119LC

TOTAL TIME: 2,385.9
LANDINGS: 1,187

ENGINES: Pratt & Whitney PW530A
(Pratt & Whitney ESP Gold Engine Program)
4,000 Hour TBO



AVIONICS EQUIPMENT: **ADS-B compliant, and LPV Certified**

COMMUNICATION:	Garmin GTN 750 GPS/NAV/COMM/MFD
VHF NAVIGATION:	Garmin GTN 750 GPS/NAV/COMM/MFD
FLIGHT DIRECTOR:	Honeywell Primus 1000 Integrated Avionics System
AUTOPILOT:	Honeywell Primus 1000 Integrated Avionics System
EFIS:	Honeywell Primus 1000, 3-Tube Integrated System
RADAR:	Honeywell WC-880 Weather Radar
STORMSCOPE:	L3 Technologies WX-1000E Stormscope
XM:	Garmin GDL-69A Satellite Radio Data Link
TRANSPONDER:	Dual Garmin GTX-345R ADS-B In/Out

GLOBAL HEADQUARTERS

5525 N.W. 15th Avenue, Suite 301B · Fort Lauderdale, Florida 33309
+1 (954) 703-1600 · www.eastcoastjetcenter.com

FORT LAUDERDALE * MONTERREY * SAO PAULO * MOSCOW

Specifications



2001 Cessna Citation Bravo

550B-0969 N119LC

DME: Dual Bendix/King KN-63 Distance Measuring Equipment
AUDIO: Garmin GMA 35 Audio Panel
HF: Honeywell KHF-950 High Frequency Radio (provisions)
RADIO ALTIMETER: Rockwell Collins ALT-55B Radar Altimeter
AIR DATA COMPUTER: Dual Honeywell AZ-850 Air Data Computer
DIRECTIONAL GYRO: Dual Honeywell C-14D Directional Gyro
VERTICAL GYRO: Dual Honeywell VG-14A Vertical Gyro
AHRS: Dual Litef LCR-93 Altitude Heading Reference System
TCAS: Bendix/King TCAS I (TPU-66A) Terminal Collision Avoidance System
EGPWS: Honeywell KGP-860 (TAWS B) Terrain Awareness & Warning System
ELT: ARTEX C406N Emergency Locator Transmitter

CAPABILITIES:

RVSM: Yes, Factory Standard



GLOBAL HEADQUARTERS
5525 N.W. 15th Avenue, Suite 301B · Fort Lauderdale, Florida 33309
+1 (954) 703-1600 · www.eastcoastjetcenter.com

FORT LAUDERDALE * MONTERREY * SAO PAULO * MOSCOW



2001 Cessna Citation Bravo

550B-0969 N119LC



INTERIOR: Standard Citation Bravo (7+ 2 + Belted Lavatory), Center Club, Two Aft Forward-facing Seats, Rear Facing Seat across from Galley, including Belted Lavatory. Passenger Seats are Tan Leather, Window Reveals in Vanilla-Colored Fabric, Lower Sidewalls in complementing Beige Fabric. The Carpet in Flannel Cut Pile, and Cabinetry in High Gloss Dark laminate finish with Satin Nickel Hardware.

GLOBAL HEADQUARTERS
5525 N.W. 15th Avenue, Suite 301B · Fort Lauderdale, Florida 33309
+1 (954) 703-1600 · www.eastcoastjetcenter.com

FORT LAUDERDALE * MONTERREY * SAO PAULO * MOSCOW

2001 Cessna Citation Bravo

550B-0969 N119LC

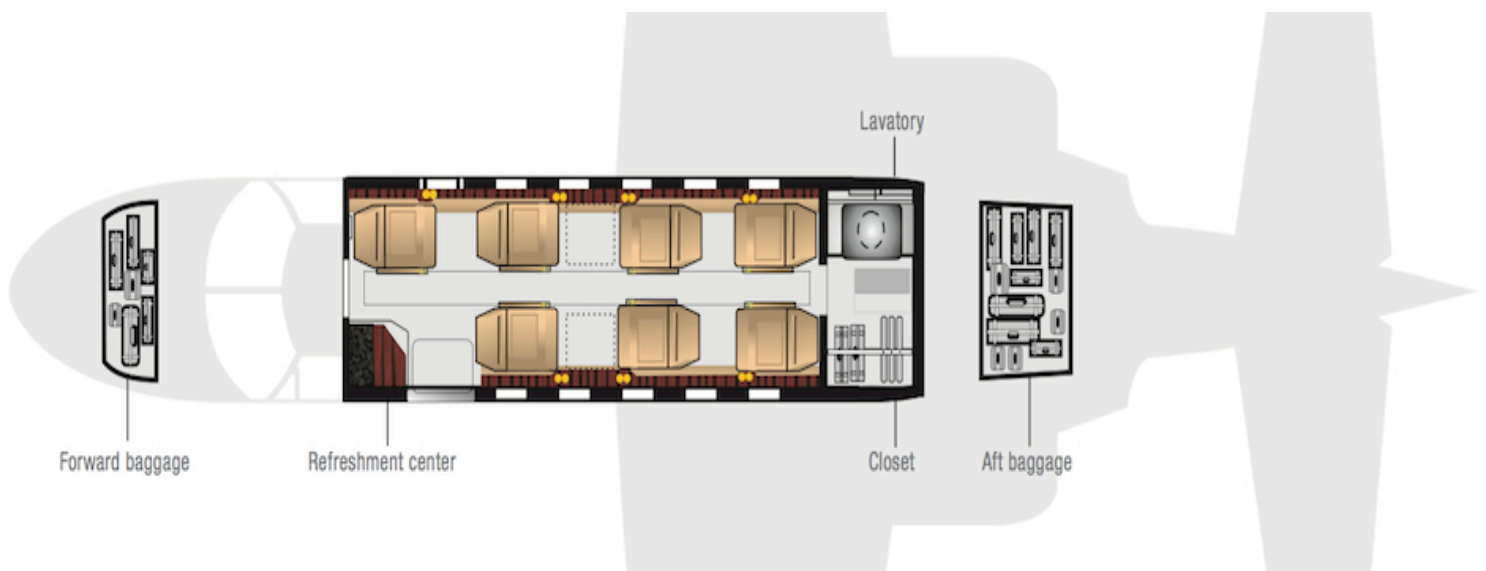

Floor Plan

MAINTENANCE & INSPECTION:

- Fresh 1-4 by Cessna Citation Orlando 05/2018
- Cessna ProParts Parts Program
- CESCO maintenance tracking program
- Jet-Tech STC ST02427LA ADS-B (In/Out)
- USB port installed in cockpit
- Shadin ADC 200 Digital Fuel Flow
- Flight Stream 510
- Digital USB Cockpit Clocks (2)
- Encore Entry Step

BRIEF HISTORY:

No known damage history

This aircraft is being brokered by East Coast Jet Center, Inc. Prospective purchasers are encouraged to conduct their own independent pre-purchase inspection as East Coast Jet Center, Inc. makes no representations as to the airworthiness of the aircraft or the accuracy of the above information. Specifications subject to verification upon inspection. Aircraft subject to prior sale.

GLOBAL HEADQUARTERS
5525 N.W. 15th Avenue, Suite 301B · Fort Lauderdale, Florida 33309
+1 (954) 703-1600 · www.eastcoastjetcenter.com

FORT LAUDERDALE * MONTERREY * SAO PAULO * MOSCOW



2001 Cessna Citation Bravo

550B-0969 N119LC



Encore Entry Step

GLOBAL HEADQUARTERS
5525 N.W. 15th Avenue, Suite 301B · Fort Lauderdale, Florida 33309
+1 (954) 703-1600 · www.eastcoastjetcenter.com

FORT LAUDERDALE * MONTERREY * SAO PAULO * MOSCOW



2001 Cessna Citation Bravo

550B-0969 N119LC



EXTERIOR: Overall Matterhorn White, Red and Blue Accent Striping.

GLOBAL HEADQUARTERS
5525 N.W. 15th Avenue, Suite 301B · Fort Lauderdale, Florida 33309
+1 (954) 703-1600 · www.eastcoastjetcenter.com

FORT LAUDERDALE * MONTERREY * SAO PAULO * MOSCOW



2001 Cessna Citation Bravo

550B-0969 N119LC



Executive Table

This aircraft is being brokered by East Coast Jet Center, Inc. Prospective purchasers are encouraged to conduct their own independent pre-purchase inspection as East Coast Jet Center, Inc. makes no representations as to the airworthiness of the aircraft or the accuracy of the above information. Specifications subject to verification upon inspection. Aircraft subject to prior sale.

GLOBAL HEADQUARTERS
5525 N.W. 15th Avenue, Suite 301B · Fort Lauderdale, Florida 33309
+1 (954) 703-1600 · www.eastcoastjetcenter.com

FORT LAUDERDALE * MONTERREY * SAO PAULO * MOSCOW



2001 Cessna Citation Bravo

550B-0969 N119LC



Fully Enclosed Belted Lavatory

This aircraft is being brokered by East Coast Jet Center, Inc. Prospective purchasers are encouraged to conduct their own independent pre-purchase inspection as East Coast Jet Center, Inc. makes no representations as to the airworthiness of the aircraft or the accuracy of the above information. Specifications subject to verification upon inspection. Aircraft subject to prior sale.

GLOBAL HEADQUARTERS
5525 N.W. 15th Avenue, Suite 301B · Fort Lauderdale, Florida 33309
+1 (954) 703-1600 · www.eastcoastjetcenter.com

FORT LAUDERDALE * MONTERREY * SAO PAULO * MOSCOW



2001 Cessna Citation Bravo

550B-0969 N119LC



Forward Galley

GLOBAL HEADQUARTERS
5525 N.W. 15th Avenue, Suite 301B · Fort Lauderdale, Florida 33309
+1 (954) 703-1600 · www.eastcoastjetcenter.com

FORT LAUDERDALE * MONTERREY * SAO PAULO * MOSCOW