



2002 Cessna Citation Bravo 550B-1007 N664DF



Specifications

This aircraft is being brokered by East Coast Jet Center, Inc. Prospective purchasers are encouraged to conduct their own independent pre-purchase inspection as East Coast Jet Center, Inc. makes no representations whatsoever as to the airworthiness of the aircraft or the accuracy of the above information. Specifications subject to verification upon inspection. Aircraft subject to prior sale.

GLOBAL HEADQUARTERS
5525 N.W. 15th Avenue, Suite 301B · Fort Lauderdale, Florida 33309
+1 (954) 703-1600 · www.eastcoastjetcenter.com

FORT LAUDERDALE * MONTERREY * SAO PAULO * MOSCOW



2002 Cessna Citation Bravo 550B-1007 N664DF

TOTAL TIME: 3,517.6

LANDINGS: 2,301

ENGINES: Pratt & Whitney PW530A

(100% JSSI Engine Program) can be purchased without.

4,000 Hour TBO



AVIONICS EQUIPMENT:

Honeywell Primus 1000 Integrated Avionics System 3 – Tube EFIS

COMMUNICATION:

Dual Bendix/King KY196B Comm

VHF NAVIGATION:

Dual Bendix/King KN53 Nav Receiver

FLIGHT DIRECTOR:

Honeywell Primus 1000 Integrated Avionics System

AUTOPILOT:

Honeywell Primus 1000 Integrated Avionics System

EFIS:

Honeywell Primus 1000, 3-Tube Integrated System

RADAR:

Honeywell WC-660 Weather Radar

TRANSPONDER:

Dual Bendix/King MST-67A Mode S Diversity w/ Enhanced
Surveillance capability

ADF:

Bendix/King KR-87 Automatic Direction Finder

DME:

Dual Bendix/King KN-63 Distance Measuring Equipment

GLOBAL HEADQUARTERS

5525 N.W. 15th Avenue, Suite 301B · Fort Lauderdale, Florida 33309

+1 (954) 703-1600 · www.eastcoastjetcenter.com

FORT LAUDERDALE * MONTERREY * SAO PAULO * MOSCOW



2002 Cessna Citation Bravo

550B-1007 N664DF

HF: Honeywell KHF-950 w/KFS-594 Ctl. High Frequency Radio
RADIO ALTIMETER: Rockwell Collins ALT-55B Radar Altimeter
AIR DATA COMPUTER: Dual Honeywell AZ-850 Air Data Computer
DIRECTIONAL GYRO: Dual Honeywell C-14D Directional Gyro
VERTICAL GYRO: Dual Honeywell VG-14A Vertical Gyro
AHRS: Dual Litef LCR-93 Altitude Heading Reference System
FMS / GPS Dual Universal UNS-1K+ Flight Management System/ Global Positioning System
TCAS: Bendix/King TCAS II Terminal Collision Avoidance System
TAWS: Honeywell Mark VII EGPWS (TAWS A) Terrain Awareness & Warning System
ELT: ARTEX C406N Emergency Locator Transmitter

CAPABILITIES:

RVSM: Yes, Factory Standard



GLOBAL HEADQUARTERS
5525 N.W. 15th Avenue, Suite 301B · Fort Lauderdale, Florida 33309
+1 (954) 703-1600 · www.eastcoastjetcenter.com

FORT LAUDERDALE * MONTERREY * SAO PAULO * MOSCOW



2002 Cessna Citation Bravo

550B-1007 N664DF



INTERIOR: Standard Citation Bravo (7+ 2 + Belted Lavatory), Center Club, Two Aft Forward-facing Seats, Rear Facing Seat across from Galley, including Belted Lavatory. Passenger Seats are Tan Leather, Window Reveals in Vanilla-Colored Fabric, Lower Sidewalls in complementing Beige Fabric. The Carpet in Flannel Cut Pile, and Cabinetry in High Gloss Dark laminate finish with Satin Nickel Hardware.

This aircraft is being brokered by East Coast Jet Center, Inc. Prospective purchasers are encouraged to conduct their own independent pre-purchase inspection as East Coast Jet Center, Inc. makes no representations whatsoever as to the airworthiness of the aircraft or the accuracy of the above information. Specifications subject to verification upon inspection. Aircraft subject to prior sale.

GLOBAL HEADQUARTERS
5525 N.W. 15th Avenue, Suite 301B · Fort Lauderdale, Florida 33309
+1 (954) 703-1600 · www.eastcoastjetcenter.com

FORT LAUDERDALE * MONTERREY * SAO PAULO * MOSCOW

2002 Cessna Citation Bravo

550B-1007 N664DF

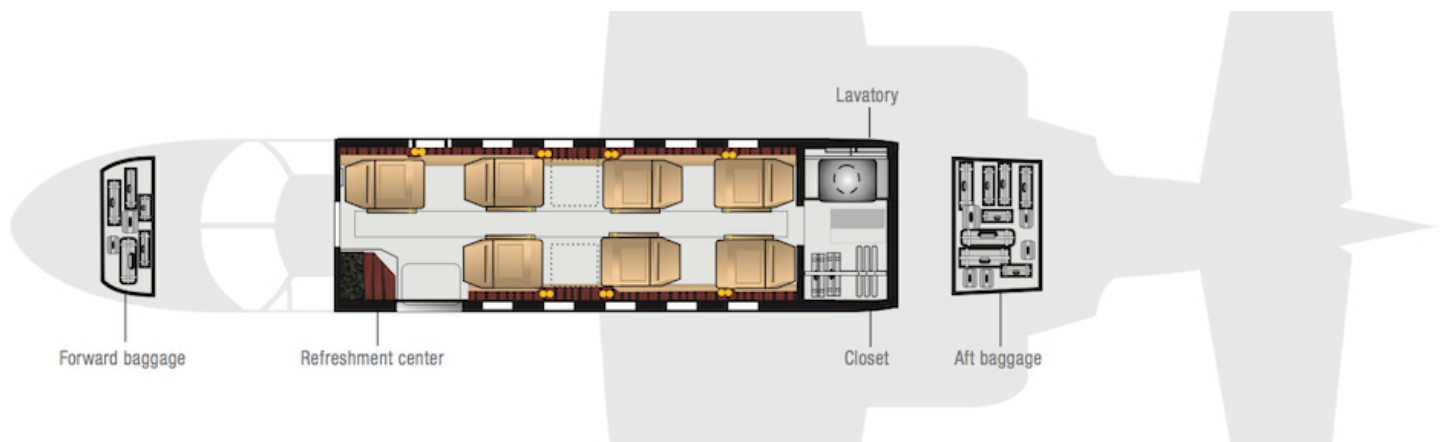

Floor Plan

MAINTENANCE & INSPECTION:

- Fresh 1-4 by Cessna Citation Orlando 12/2017
- CESCO maintenance tracking program

BRIEF HISTORY:

No known damage history

AVAILABLE: IMMEDIATELY

This aircraft is being brokered by East Coast Jet Center, Inc. Prospective purchasers are encouraged to conduct their own independent pre-purchase inspection as East Coast Jet Center, Inc. makes no representations whatsoever as to the airworthiness of the aircraft or the accuracy of the above information. Specifications subject to verification upon inspection. Aircraft subject to prior sale.

GLOBAL HEADQUARTERS
5525 N.W. 15th Avenue, Suite 301B · Fort Lauderdale, Florida 33309
+1 (954) 703-1600 · www.eastcoastjetcenter.com

FORT LAUDERDALE * MONTERREY * SAO PAULO * MOSCOW



2002 Cessna Citation Bravo

550B-1007 N664DF



EXTERIOR: Overall Matterhorn White, Red and Black Accent Striping.

GLOBAL HEADQUARTERS
5525 N.W. 15th Avenue, Suite 301B · Fort Lauderdale, Florida 33309
+1 (954) 703-1600 · www.eastcoastjetcenter.com

FORT LAUDERDALE * MONTERREY * SAO PAULO * MOSCOW



2002 Cessna Citation Bravo

550B-1007 N664DF



Executive Table

This aircraft is being brokered by East Coast Jet Center, Inc. Prospective purchasers are encouraged to conduct their own independent pre-purchase inspection as East Coast Jet Center, Inc. makes no representations whatsoever as to the airworthiness of the aircraft or the accuracy of the above information. Specifications subject to verification upon inspection. Aircraft subject to prior sale.

GLOBAL HEADQUARTERS
5525 N.W. 15th Avenue, Suite 301B · Fort Lauderdale, Florida 33309
+1 (954) 703-1600 · www.eastcoastjetcenter.com

FORT LAUDERDALE * MONTERREY * SAO PAULO * MOSCOW



2002 Cessna Citation Bravo

550B-1007 N664DF



Belted Lavatory

This aircraft is being brokered by East Coast Jet Center, Inc. Prospective purchasers are encouraged to conduct their own independent pre-purchase inspection as East Coast Jet Center, Inc. makes no representations whatsoever as to the airworthiness of the aircraft or the accuracy of the above information. Specifications subject to verification upon inspection. Aircraft subject to prior sale.

GLOBAL HEADQUARTERS
5525 N.W. 15th Avenue, Suite 301B · Fort Lauderdale, Florida 33309
+1 (954) 703-1600 · www.eastcoastjetcenter.com

FORT LAUDERDALE * MONTERREY * SAO PAULO * MOSCOW

2002 Cessna Citation Bravo

550B-1007 N664DF



Forward Galley